

m:\12\17\09 11:50am - P:\P\POB\0000047\0400CAD\DWG\Sheets\PUD\vs\POB03\pobm0047.dwg

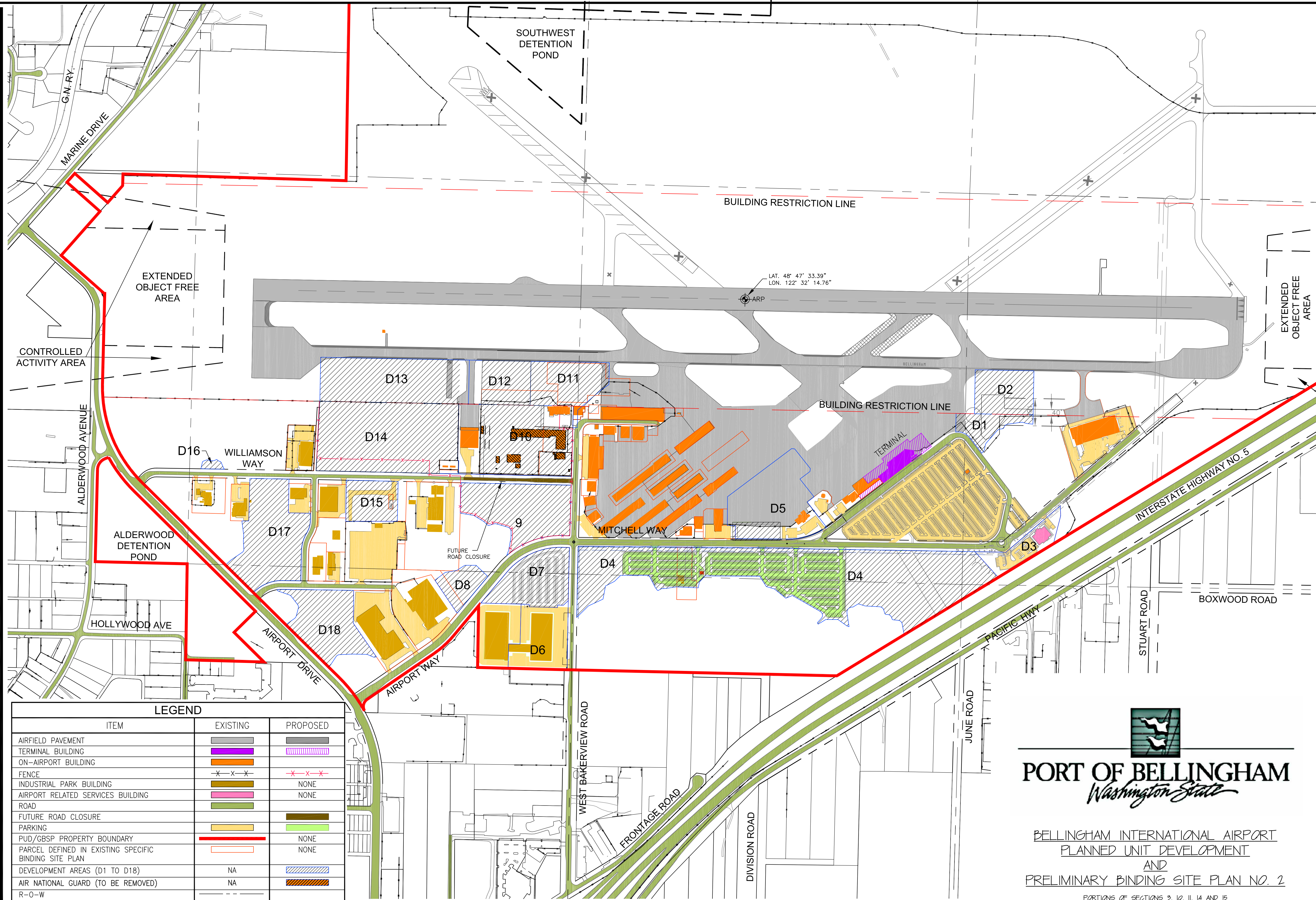

BELLINGHAM INTERNATIONAL AIRPORT
 PLANNED UNIT DEVELOPMENT
 AND
 PRELIMINARY BINDING SITE PLAN NO. 2

PORTIONS OF SECTIONS 3, 12, 11, 14 AND 15
 TOWNSHIP 38 NORTH, RANGE 2 EAST OF WM. WHATCOM COUNTY, WASHINGTON



DAVID EVANS AND ASSOCIATES, INC.
 119 Grand Avenue, Suite D
 Bellingham Washington 98225
 Phone: 360.647.7151
 Fax: 360.647.7160

PORT OF BELLINGHAM
 BELLINGHAM INTERNATIONAL AIRPORT
**PLANNED UNIT DEVELOPMENT AND
 PRELIMINARY BINDING SITE PLAN NO. 2**
 PUD CONCEPTUAL SITE PLAN

PROJECT NUMBER:
 POB00047
 DATE: DEC. 03, 2009
 DESIGN: JXWA
 CHECKED:

SCALE: AS NOTED

SHEET NO.
3

OF

NO. REVISIONS:
 APPD.